

CBD20N1 Economical Pallet Truck

LONKING

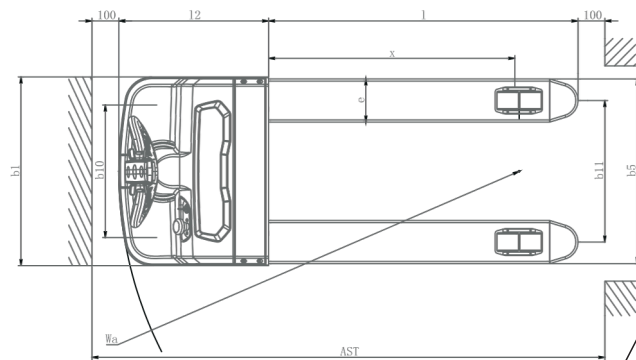
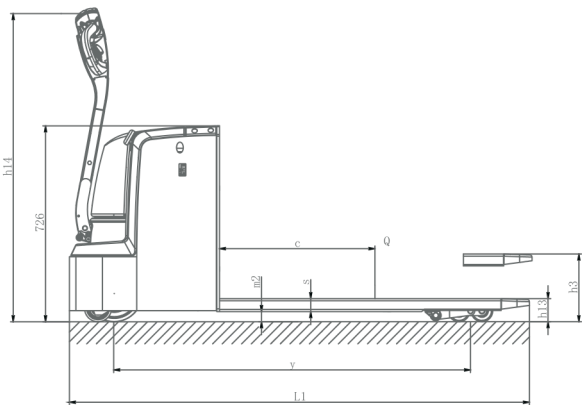

Main technical parameters of CBD20N1 Economical Pallet Truck

Features	Type		CBD20N1	CBD20N1
	Driving Mode		electric	electric
	Operating Mode		pedestrian	pedestrian
	Rated Load Capacity	Q (t)	2	2
	Load Center	c (mm)	600	600
	Front Overhang	x (mm)	931	931
	Wheelbase	y (mm)	1324	1324
	Dead Weight(Including Battery)	kg	333	333
Tire Chassis	Tire Type		Polyurethane	Polyurethane
	Driving Wheel Size	Φ × w (mm)	Φ 210 × 70	Φ 210 × 70
	Bearing Wheel Size	Φ × w (mm)	Φ 80 × 70	Φ 80 × 70
	Balance Wheel Size	Φ × w (mm)	Φ 100 ×	Φ 100 × 40
	Number of Driving Wheel, Balance Wheel and Bearing Wheel(x=Driving Wheel)		1x + 2/4	1x + 2/4
	Track Width, Bearing Side	b (mm)	380 / 525	380 / 525
	Lifting Height	h3 (mm)	200	200
	Minimum/maximum Height of Handle Lever in Operating Position	h (mm)	730 / 1165	730 / 1165
Size	Minimum Fork Height	h (mm)	85	85
	Vehicle Length	l (mm)	1708	1708
	Body Length	l2 (mm)	558	558
	Vehicle Width	b / b (mm)	700	700
	Fork Size	s/e/l (mm)	50 / 160 / 1150	50 / 160 / 1150
	Outer Width of Fork	b5 (mm)	540 / 685	560 / 685
	Ground Clearance of Wheelbase Centre	m (mm)	35	35
	Aisle Width: 1000x1200 Pallet (1200 Placed across the Fork)	Ast (mm)	1909	1909
	Aisle Width: 800x1200 Pallet (1200 Placed along the Fork)	Ast (mm)	1959	1959
	Turning Radius	Wa (mm)	1490	1490
	Driving Speed(Full Load/No Load)	(km/h)	4.2/4.5	4.2/4.5
	Lifting Speed Full Load/No Load	(mm/s)	20/26	20/26
Performance	Lowering Speed Full Load/No Load	(mm/s)	33/21	33/21
	Maximum Grade Full Load/No Load	(%)	3/10	8/15
	Braking Type		Electromagnetic Brake	Electromagnetic Brake
	Driving Motor	(kW)	0.75	0.75
Motor	Lifting Motor Powe	(kW)	0.8	0.8
	Battery, According to DIN 43531/35/36 A,B,C,no		no	no
	Battery Voltage/Capacity	(V/Ah)	2 × 12 / 100	2 × 12 / 100
	Battery Weight (± 5%)	(kg)	54	54
Others	Drive Control Type		DC Speed Control	DC Speed Control
	Noise Level	(dB (A))	≤ 70	≤ 70
	Steering Type		Mechanical Steering	Mechanical Steering